

EZ Up Inversion Rack

Items for Assembly:

- Large diameter 'L' Bar
- Small diameter 'L' Bar
- Small Straight Bar w/ Warning Label
- Large Straight Bar w/ Blue Foam
- Large diameter 'Elbow' Bar w/ Doorstop
- Small diameter 'Elbow' Bar w/ Doorstop
- Two (2) Brackets
- Four (4) 2" (5 cm) Bolts
- Two (2) Bolts: 1 - 1¾" (4.4 cm); 1 - 1½" (3.8 cm)
w/ Lock Nuts
- Six (6) 2" (5 cm) Wood Screws

Not included: Medium Phillips Head screwdriver,
Adjustable Wrench, Drill motor w/ 5/32" drill bit.

Items for Assembly:

- Blue Foam
- Doorstop for Large 'Elbow' Bar
- Doorstop for Small 'Elbow' Bar
- Farings (for Elbow Bars) - set
 - Small Bar Farings Only
 - Large Bar Farings Only

- Item #
- E1-1040
- E1-1047
- E1-1043
- E1-1052
- E1-1054
- E1-1059
- H1-1905
- H1-1904
- H1-3011
- H1-5005

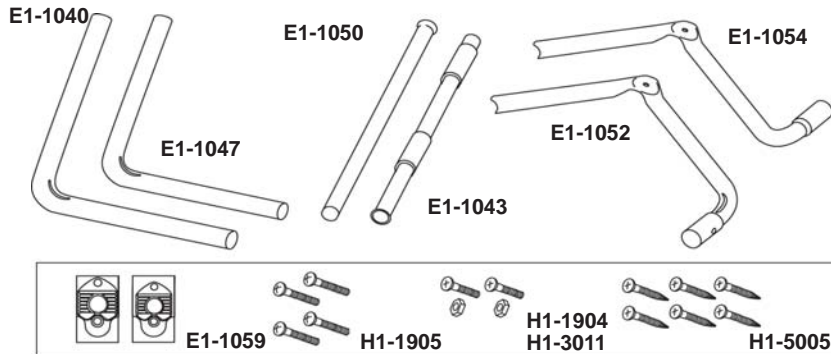

STL Instructional Materials

- Assembly Instructions/Owner's Manual
- Instructional DVD
- Warranty Card
- Brochure
- Better Back Book (System only)

Item

- LE-1017
- LD-1005
- LF-5008
- LE-1016
- LM-1001

IIL/Teeter Ltd. Instructional Materials

- EURO Packet*
- Better Back Book (System only) - German

Item

- II-L530
- LM-1005

*Features Languages: English, French, German, Dutch, Spanish, Italian and Portuguese